

# DE-710 STEEL SQUARE LOCK CONDUIT

## UL RECOGNIZED

FMC STEEL FLEX DE-710  
STANDARD FLEXIBLE CONDUIT

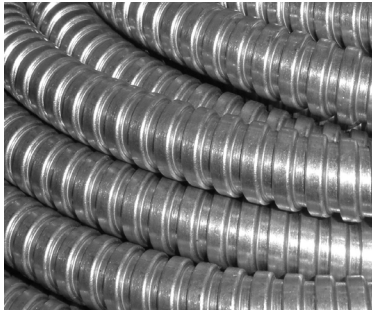
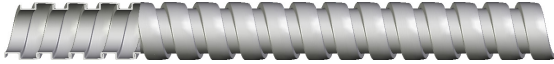

### SPECIFICATIONS

- Constructed of continuously interlocked hot dipped zinc galvanized steel core for exceptional crush and corrosion resistance
- Temperature: +450°F (+232°C) max.
- Exceptional flexibility for tight "U" bend radius

### APPLICATIONS

- OEM applications in office furniture and medical markets

See: [www.ul.com](http://www.ul.com) [www.nfpa.org](http://www.nfpa.org) [www.naed.org](http://www.naed.org)  
[www.nema.org](http://www.nema.org) [www.anacondasealtite.com](http://www.anacondasealtite.com)

### DESCRIPTION

- Ultra flexible galvanized steel conduit
- Designed for OEM applications in the office furniture and medical industries
- CSA Acceptable #LO-4000, 4158
- UL 1 Recognized DXUZ2.E39679
- Also available in an OVAL version (consult factory)
- Additional Put-ups available



Square-Locked Design

DE-710:



Actual ID Size	Item ID	Std. Pkg. (feet)	Inside Diameter (inches)		Outside Diameter (inches)		Bend Radius (inches)	Weight (lbs/100 ft)
			Min	Max	Min	Max		
5/16"	452100	Available In Random Lengths	0.312	0.337	0.456	0.481	1.3	11
3/8"	452105		0.375	0.400	0.519	0.544	1.3	12
7/16"	452110		0.437	0.462	0.581	0.606	1.5	13
1/2"	452115		0.500	0.525	0.644	0.669	1.5	15
9/16"	452120		0.562	0.587	0.708	0.731	1.5	19
5/8"	452125		0.594	0.619	0.738	0.763	1.8	17
3/4"	452130		0.696	0.726	0.840	0.870	2.3	20

D  
E  
-  
7  
1  
0