

# DSL STEEL SQUARE LOCK CONDUIT

## FMC STEEL FLEX DSL NON-JACKETED EXTRA FLEXIBLE STEEL CONDUIT

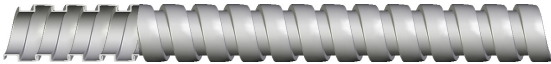

### SPECIFICATIONS

- Constructed of continuously interlocked hot dipped zinc galvanized steel core for exceptional crush and corrosion resistance
- Temperature: +450°F (+232°C) max.
- Exceptional flexibility for tight "U" bend radius

### APPLICATIONS

- OEM applications where tight bend radius is required, but no approvals are required

See: [www.ul.com](http://www.ul.com) [www.nfpa.org](http://www.nfpa.org) [www.naed.org](http://www.naed.org)  
[www.nema.org](http://www.nema.org) [www.anacondasealtite.com](http://www.anacondasealtite.com)

### DESCRIPTION

- Ultra flexible galvanized steel conduit
- Designed for OEM applications where high flexibility but no approvals are required
- Installs easily using standard armored or flexible conduit connectors
- Additional Put-ups available



Square-Locked Design



Actual ID Size	Description ID	Item ID	Std. Pkg. (feet)	Inside Diameter (inches)		Outside Diameter (inches)		Bend Radius (inches)	Weight (lbs/100ft)
				Min	Max	Min	Max		
3/16"	DSL-3	460012	250	0.183	0.195	0.263	0.275	1	5
1/4"	DSL-4	460022	250	0.245	0.260	0.335	0.350	1	6
5/16"	DSL-5	460032	250	0.307	0.322	0.417	0.432	1.2	8
3/8"	DSL-6	460042	200	0.368	0.388	0.478	0.498	1.5	9
7/16"	DSL-7	460052	200	0.430	0.450	0.545	0.565	1.5	12
1/2"	DSL-8	460057	200	0.493	0.513	0.613	0.633	1.5	13
9/16"	DSL-9	460067	200	0.555	0.575	0.680	0.700	1.5	14
5/8"	DSL-10	460072	150	0.618	0.638	0.743	0.763	2.0	14
3/4"	DSL-12	460077	150	0.740	0.770	0.865	0.895	2.0	18