

# Type SL

Square Lock  
Stainless Steel Stripwound Hose



### Construction

- Constructed of continuously interlocked Type 302 stainless steel core for exceptional crush and corrosion resistance.
- Extruded PVC, Silicone, Teflon, and Thermoplastic Rubber jackets available upon request.
- Available in brass, galvanized steel and aluminum.



Square Lock Construction

### Applications

- Fiber Optics
- Instrumentation
- Sensors
- Recording Instruments
- Temperature Measuring Devices



[www.nema.org](http://www.nema.org)  
[www.naed.org](http://www.naed.org)  
[www.anametelectrical.com](http://www.anametelectrical.com)

• RoHS WEEE COMPLIANT



## Type SL

Stainless Steel Stripwound Hose

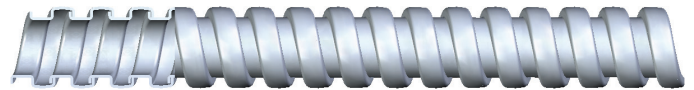

### Product Specifications

### Ordering Information

Nominal Size		Inside Diameter		Outside Diameter		Approx Inside Bend Radius	Approx Weight lbs.	Standard Reel	
Inches	mm	Inches		Inches				Inches	PER 100 FT.
		MIN.	MAX.	MIN.	MAX.				
1/8	3	.125	.137	.195	.207	1	2.3	1000	460610-0070
5/32	4	.152	.164	.232	.244	1	3.4	1000	460613-0070
3/16	5	.183	.195	.263	.275	1	3.7	1000	460615-0074
7/32	5.6	.206	.221	.291	.306	1	4.1	1000	460619-0070
1/4	6.3	.245	.260	.330	.345	1-1/4	4.8	800	460622-0074
9/32	7	.276	.291	.361	.376	1-1/4	5.4	600	460625-0070
5/16	8	.302	.317	.412	.427	1-1/4	6.7	500	460628-0070
3/8	9	.363	.383	.473	.493	1-1/2	7.9	275	460634-0074
1/2	13	.483	.503	.603	.623	1-1/2	10.8	250	460643-0070
5/8	15	.605	.625	.735	.755	2	12.2	250	460652-0070

NOTE: 1. Other sizes available on special order.  
 2. Available in brass, galvanized steel and aluminum.