



ISO Metric Compact Fittings

Construction

- Nickel plated brass fitting, has a four piece construction consisting of a gland nut, sealing ring, high tensile grounding cone and body.
- Included sealing ring and galvanized steel lock nut provides a means for connecting the fitting to boxes.
- Excellent corrosion resistance, strength and durability.



Straight Fitting ISO Thread 3/8" through 2"



90° Fitting ISO Thread 3/8" through 2"

Installation

- Fitting is ideal for use with standard liquid-tight conduit to allow easy installation. IP 66/67 Rated when installed with approved conduit.
- Approved for both exposed and concealed locations. Rated for temperature ranges -49°F to + 221°F (-45°C to +105°C).
- Suitable for harsh industrial, food and beverage, petrochemical, waste water, salt water and other corrosive applications
- Suitable for use in hazardous locations per NEC Articles 501 Class I Div. 2, Article 502 Class II Div. 1 & 2, Article 503 Class III Div. 1 & 2.
- Compact design is ideal for tight spaces.
- Complies with UL Standard 514B and CSA C22.2 combined File No. E234207

NEC Articles

- Article 501.10 (B) (2) Class I Div. 2
- Article 502.10 (A) (2) and (B) (2) Class II Div. 1 & 2
- Article 503.10 (A) (3) and (B) Class III Div. 1 & 2

www.ul.com
www.nfpa.org
www.nema.org

www.csa-international.org
www.naed.org
www.anametelectrical.com

U.L. LISTED  • CSA CERTIFIED  • RoHS WEEE COMPLIANT

ISO Metric Straight Compact Fittings

Thread	Sealtite Size (inch)	Min. Internal Bore (mm)	Dimensions in mm					Standard Package	Article Number	Weight (Lbs/100)
			A	B	C	D	E			
M16 x 1.5	3/8"	10.4	30	10	26	-	24	10	7120161	9.3
M20 x 1.5	3/8"	10.4	30	10	26	-	24	10	7120171	9.7
M20 x 1.5	1/2"	13.8	32	10	29	-	27	10	7120201	11.0
M25 x 1.5	3/4"	18.5	33	10	35	-	33	10	7120251	16.3
M32 x 1.5	1"	23.8	36	12	45	-	44	5	7120321	30.6
M40 x 1.5	1 1/4"	31.9	40	13	53	-	50	2	7120401	41.4
M50 x 1.5	1 1/2"	36.9	46	14	62	-	58	2	7120501	63.9
M63 x 1.5	2"	47.9	52	16	76	-	72	2	7120631	95.7

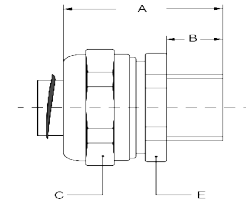

ISO Metric 90° Compact Fittings

Thread	Sealtite Size (inch)	Min. Internal Bore (mm)	Dimensions in mm					Standard Package	Article Number	Weight (Lbs/100)
			A	B	C	D	E			
M16 x 1.5	3/8"	10.4	26	10	26	31	22	10	7129161	15.4
M20 x 1.5	3/8"	10.4	26	10	26	32	24	10	7129171	15.9
M20 x 1.5	1/2"	13.8	28	10	29	34	27	10	7129201	18.5
M25 x 1.5	3/4"	18.5	32	10	35	40	33	10	7129251	38.6
M32 x 1.5	1"	23.8	40	12	45	49	42	5	7129321	64.8
M40 x 1.5	1 1/4"	31.9	46	13	53	50	52	2	7129401	91.7
M50 x 1.5	1 1/2"	36.9	56	14	62	57	60	2	7129501	129.2
M63 x 1.5	2"	47.9	62	16	76	68	72	2	7129631	209.0

